



**Highclere Road, Quedgeley, Gloucester**

Freehold

**Offers in Excess of £299,995**

**50 Highclere Road, Quedgeley,  
Gloucester, Gloucestershire, GL2 4HD**

**Offers in Excess of £299,995**

Freehold. Council Tax Band D



**3 Bedrooms**



**2 Bathrooms**



**1 Receptions**

### Features

- \*Gas Central Heating \* Living/Dining Room
- \*Single Garage & Driveway \*Upvc Double Glazing
- \*No Onward Chain \* Popular Location
- \*En-Suite To Bedroom One \* Energy Rating D
- \* \*

### Michael Tuck Estate and Letting Agents

1 School Lane Quedgeley Gloucester Gloucestershire GL2 4PJ

01452 543200

estates.quedgeley@michaeltuck.co.uk

[www.michaeltuck.co.uk](http://www.michaeltuck.co.uk)

### The Property

Immaculate Three Bedroom Link-Detached Home In Highclere Road, Quedgeley!

The accommodation on the ground floor comprises of; Entrance hall, cloakroom, living/dining room, kitchen & conservatory. On the top floor we have; Three bedrooms & family bathroom.

Further benefits include; Upvc double glazing, gas central heating, en-suite to bedroom one & single garage!

Property for sale through Michael Tuck Estate Agents.

Potential rental value of £1495 pcm, please contact Michael Tuck Lettings in Quedgeley for more details.

Early viewing is essential!

To book YOUR viewing call us TODAY on 01452 543200!

**Entrance Hall** 9' 5" x 3' 4" (2.87m x 1.02m)

**WC** 5' 8" x 2' 6" (1.73m x 0.76m)

**Living Room** 13' 4" x 13' 4" (4.06m x 4.06m)

**Dining Room** 9' 1" x 7' 8" (2.77m x 2.34m)

**Kitchen** 9' 2" x 8' 7" (2.79m x 2.61m)

**Sunroom** 10' 1" x 8' 10" (3.07m x 2.69m)

**First Floor Landing** 11' 1" x 6' 1" (3.38m x 1.85m)

**Master Bedroom** 10' 11" x 8' 9" (3.32m x 2.66m)

**En-Suite** 7' 3" x 2' 4" (2.21m x 0.71m)

**Bedroom Two** 10' 9" x 0' 0" (3.27m x 0.00m)

**Bedroom Three** 7' 6" x 5' 11" (2.28m x 1.80m)

**Bathroom** 6' 2" x 5' 6" (1.88m x 1.68m)

**Garage** 17' 1" x 8' 7" (5.20m x 2.61m)

### Additional Information

Additional Information provided by vendor:

Utilities • Electricity – mains • Gas – mains • Water – mains • Sewerage – mains • Broadband – fibre to cabinet







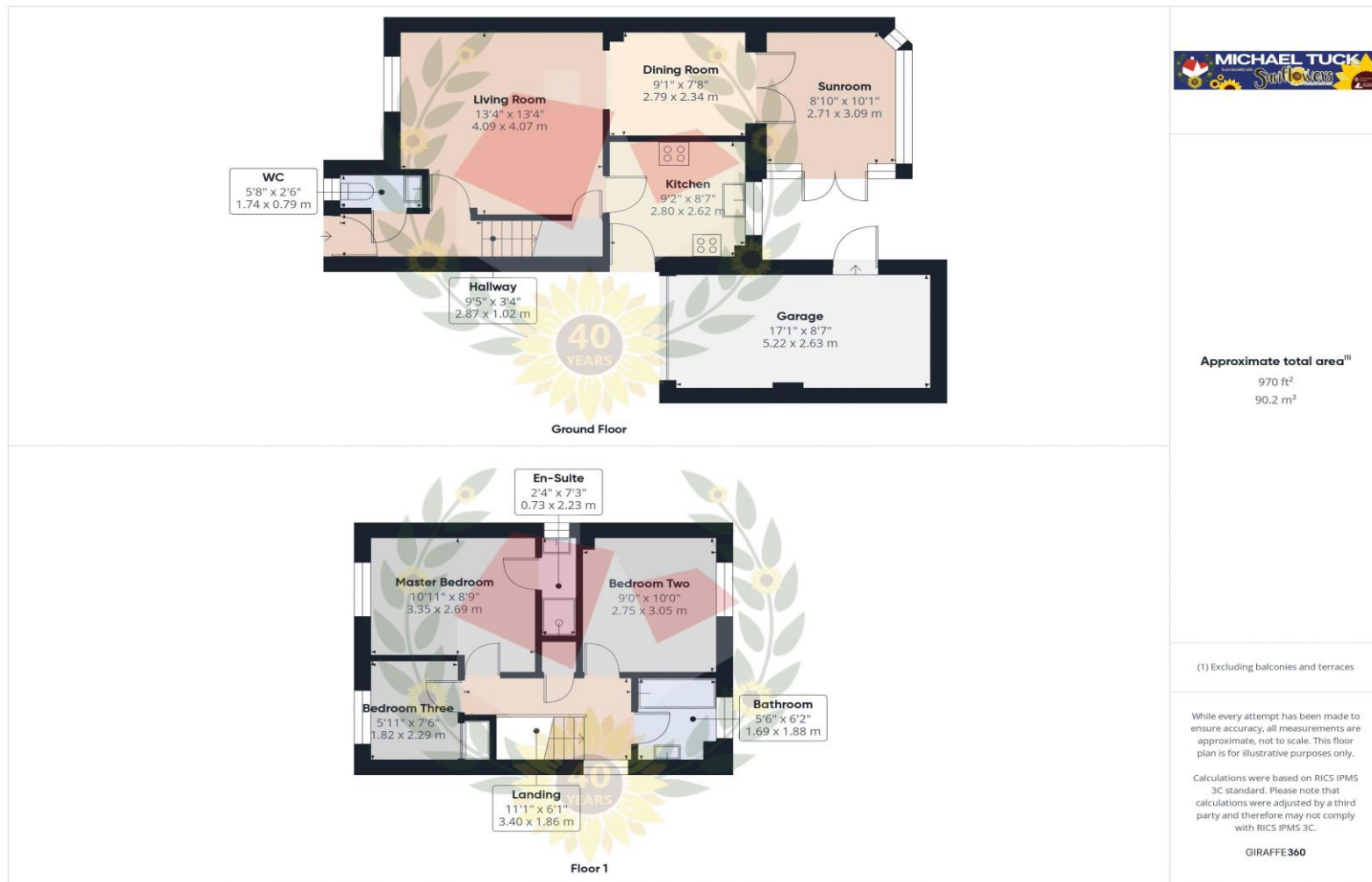

**FOR ILLUSTRATIVE PURPOSES ONLY – NOT TO SCALE**

The position and size of doors, windows, appliances, and other features are approximate only.  
Unauthorised reproduction prohibited

**Important notice:** Michael Tuck, its clients and any joints give notice that 1: They are not authorised to make or give any representations or warranties in relation to the property either here or elsewhere, either on their own behalf of their client or otherwise. They assume no responsibility for any statement that may be made in these particulars. These particulars do not form part of any offer or contract and must not be relied upon as statements or representation of fact. 2: Any areas, measurements or distances are approximate. The text, photographs and plans are for guidance only and are not necessarily comprehensive. It should not be assumed that the property has all necessary planning, building regulation or other consents and Michael Tuck have not tested any services, equipment or facilities. Purchasers must satisfy themselves by inspection or otherwise.

