



Rosedale Close, Hardwicke, Gloucester

Freehold

£275,000

**35 Rosedale Close, Hardwicke,
Gloucester, Gloucestershire, GL2 4JL**

£275,000

Freehold. Council Tax Band C



3 Bedrooms



3 Bathrooms



1 Receptions

Features

*Dales Wharf Development * Three
Bedrooms
*En-Suite To Master Bedroom *Cloakroom &
Family Bathroom
*Lounge & Kitchen Diner * UPVC Double
Glazing & Gas Radiator Central Heating
*Front & Rear Gardens * Energy Rating C74
*Allocated Parking for 2/3 Cars to Side * No
Onward Chain

Michael Tuck Estate and Letting Agents

1 School Lane Quedgeley Gloucester Gloucestershire GL2 4PJ

01452 543200

estates.quedgeley@michaeltuck.co.uk

www.michaeltuck.co.uk

The Property

We bring to the market a THREE Bedroom End Terraced house located on the highly sought after DALES WHARF Development within a short walk of the canal and is available with NO ONWARD CHAIN.

Accommodation comprises of Entrance Hall, CLOAKROOM, Lounge, Kitchen Diner, EN-SUITE & Recessed Wardrobes To Master Bedroom, Further double bedroom with wardrobe, single bedroom and family bathroom.

Further benefits include UPVC Double Glazing, Gas Radiator Central Heating, front & rear gardens and OFFROAD PARKING to side for 2/3 cars

Property for sale through Michael Tuck Estate Agents.

Potential rental value of £1450 pcm, please contact Michael Tuck Lettings in Quedgeley for more details.

Call 01452 543200 To View!

Entrance Hall

Lounge 12' 11" x 9' 9" (3.93m x 2.97m)

Kitchen Diner 18' 6" x 7' 11" (5.63m x 2.41m)

WC 4' 11" x 4' 5" (1.50m x 1.35m)

First Floor Landing

Master Bedroom 11' 10" x 8' 6" (3.60m x 2.59m)

En-Suite 6' 11" x 2' 10" (2.11m x 0.86m)

Bedroom Two 9' 11" x 7' 9" (3.02m x 2.36m)

Bedroom Three 9' 8" x 5' 9" (2.94m x 1.75m)

Family Bathroom 7' 10" x 4' 5" (2.39m x 1.35m)

Outside - Front & Rear Garden

Allocated Parking for 2/3 Cars

Additional Information

Gas & Electric - Mains

Water & Sewerage - Mains









Approximate total area⁽¹⁾
724.52 ft²
67.31 m²

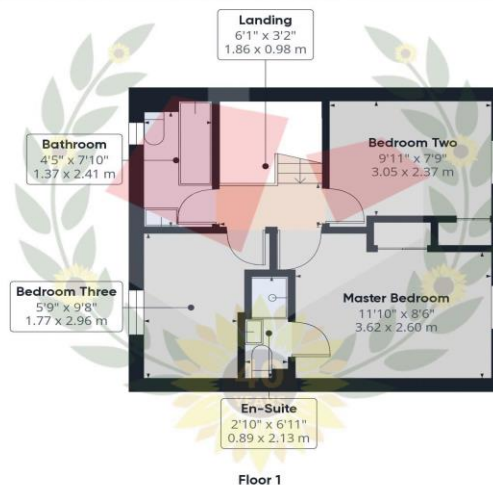

(1) Excluding balconies and terraces

While every attempt has been made to ensure accuracy, all measurements are approximate, not to scale. This floor plan is for illustrative purposes only.

Calculations are based on RICS IPMS 3C standard.

GIRAFFE360

