



**The Clock Tower, Huckley Field,
Abbeymead, Gloucester**

Leasehold

£190,000

**10 The Clock Tower, Huckley Field,
Abbeymead, Gloucester,
Gloucestershire, GL4 5SX**

£190,000

Leasehold. Council Tax Band A



2 Bedrooms



1 Bathrooms



1 Receptions

Features

- * No Onward Chain
- * Ground Floor Apartment
- * Two Bedrooms
- * Off Road Parking
- * Communal Gardens
- * Ideal First time buy
- * EPC Rating C
- * Council Tax Band A

Michael Tuck Estate and Letting Agents

2 Mead Road Abbeymead Gloucester Gloucestershire GL4 5GL

01452 612020

estates.abbeymead@michaeltuck.co.uk

www.michaeltuck.co.uk

The Property

Modern Two Bedroom Ground Floor Apartment with Off Road Parking, Communal Gardens and Offered with No Onward Chain

This well-presented two-bedroom ground floor apartment, located in the sought-after Clock Tower development, offers a fantastic opportunity for first-time buyers or investors. With its spacious layout and excellent features, this property is ideal for those looking for a comfortable, low-maintenance home in a convenient location. The apartment boasts an open-plan kitchen, dining, and living area that creates a bright and inviting space for everyday living. The kitchen is well-equipped with modern appliances and ample storage, while the living and dining areas offer plenty of room to relax and entertain. Both bedrooms provide comfortable spaces for rest and relaxation. The property also includes a stylish family bathroom. The property also benefits from Off-road parking and access to lovely communal gardens, providing a tranquil space for outdoor enjoyment. This charming apartment offers a fantastic opportunity to get onto the property ladder or expand your investment portfolio. The approximate rental value is £950 pcm. Please contact Michael Tuck Lettings in Abbeymead for further advice.

Contact us today to arrange a viewing on 01452 612020

Entrance Hall 3' 3" x 16' 7" (0.99m x 5.05m)

Hallway 12' 2" x 3' 7" (3.71m x 1.09m)

Bedroom One 8' 6" x 11' 4" (2.59m x 3.45m)

Bedroom Two 6' 5" x 11' 3" (1.95m x 3.43m)

Bathroom 7' 0" x 5' 7" (2.13m x 1.70m)

Kitchen/Lounge/Diner 10' 9" x 12' 2" (3.27m x 3.71m)

Additional Information

- Lease expiry – 01.06.2131
 - Current Ground Rent - £200 Per Annum
 - Is it a rising ground rent - Next Increase £400 per Annum in 2031
 - Current Service Charge - £1799.07 Per Annum
- Utilities
- Electricity – mains
 - Water – mains
 - Sewerage – mains
 - Broadband – fibre to cabinet







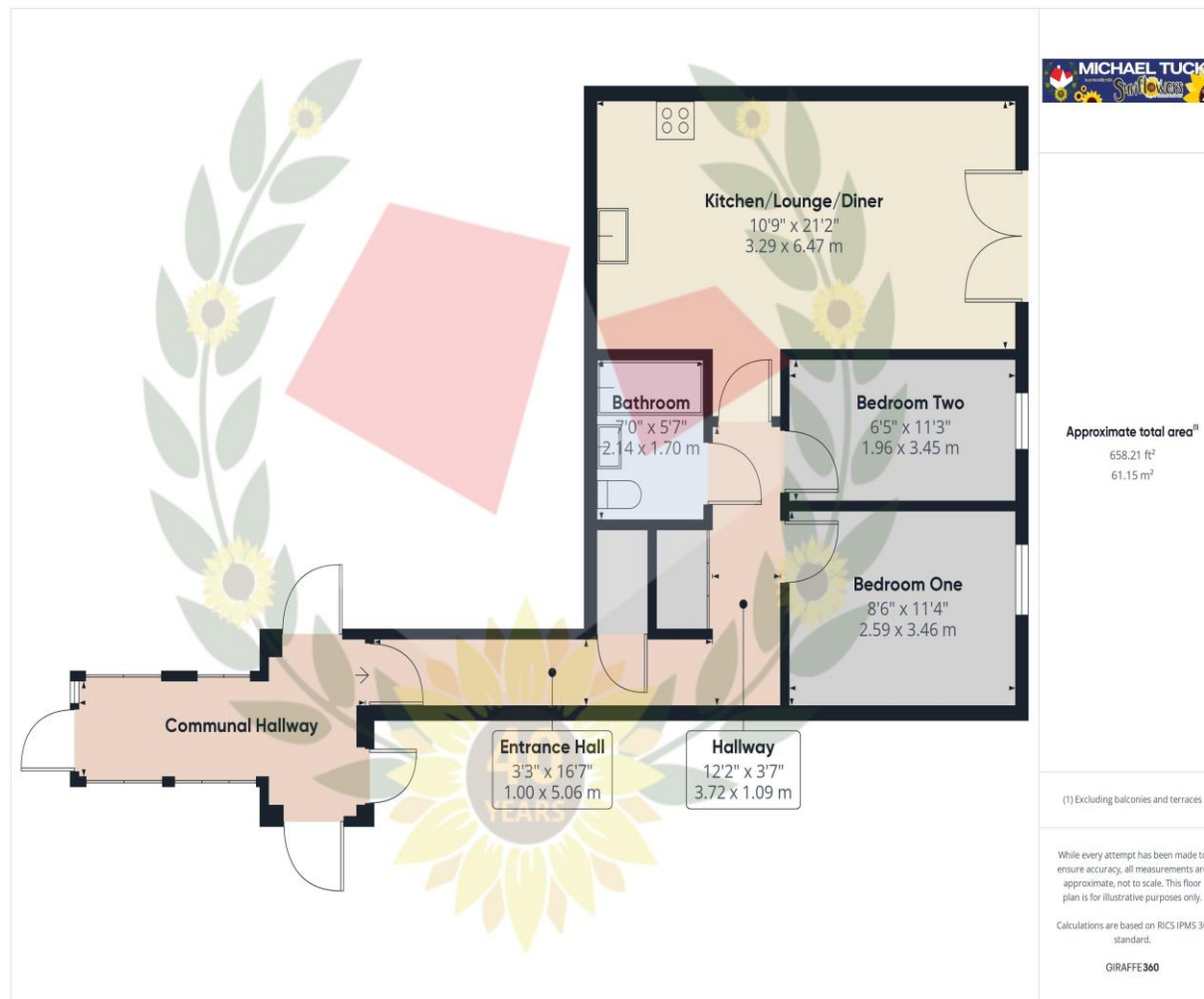

FOR ILLUSTRATIVE PURPOSES ONLY – NOT TO SCALE

The position and size of doors, windows, appliances, and other features are approximate only.
Unauthorised reproduction prohibited

Important notice: Michael Tuck, its clients and any joints give notice that 1: They are not authorised to make or give any representations or warranties in relation to the property either here or elsewhere, either on their own behalf of their client or otherwise. They assume no responsibility for any statement that may be made in these particulars. These particulars do not form part of any offer or contract and must not be relied upon as statements or representation of fact. 2: Any areas, measurements or distances are approximate. The text, photographs and plans are for guidance only and are not necessarily comprehensive. It should not be assumed that the property has all necessary planning, building regulation or other consents and Michael Tuck have not tested any services, equipment or facilities. Purchasers must satisfy themselves by inspection or otherwise.

