



Bristol Road, Gloucester

£320,000 Freehold



MICHAEL TUCK

The Agent with 5 star customer service

**287 Bristol Road, Quedgeley,
Gloucester, Gloucestershire, GL2 4QP**

£320,000

Freehold. Council Tax Band B



2 Bedrooms



1 Bathrooms



3 Receptions

Features

- *Upvc Double Glazing
- * Rarely Available
- *Great Sized Plot
- *Parking for Several Vehicles
- *Gas Central Heating
- * Two Double Bedrooms
- *Massive Potential
- * Energy Rating D

Michael Tuck Estate and Letting Agents

1 School Lane Quedgeley Gloucester Gloucestershire GL2 4PJ

01452 543200

estates.quedgeley@michaeltuck.co.uk

www.michaeltuck.co.uk

The Property

EDWARDIAN TWO BEDROOM SEMI-DETACHED HOME BUILT IN 1910 WITH 1/3RD OF AN ACRE PLOT LOCATED IN QUEDGELEY, GLOUCESTER!

The accommodation in brief comprises of; Entrance hall, living room, family room, kitchen/diner & shower room.

On the top floor we have; Two large double bedrooms.

Further benefits are: Gas central heating, upvc double glazing, a W.C to bedroom one. parking for several vehicles and potential to extend/build subject to planning!

This property is a well loved home and could benefit from general modernisation throughout and has huge potential, the property really needs to be seen to be truly appreciated.

Property for sale through Michael Tuck Estate Agents. Potential rental value of £1250 pcm, please contact Michael Tuck Lettings in Quedgeley for more details.

To arrange your viewing call us today on 01452 543200.

Hallway 4' 4" x 2' 9" (1.32m x 0.84m)

Living Room 14' 11" x 14' 10" (4.54m x 4.52m)

Family Room 14' 11" x 11' 11" (4.54m x 3.63m)

Kitchen/Diner 16' 5" x 9' 1" (5.00m x 2.77m)

Sunroom 18' 1" x 6' 1" (5.51m x 1.85m)

Utility room 8' 11" x 3' 3" (2.72m x 0.99m)

Shower Room 8' 5" x 5' 4" (2.56m x 1.62m)

First Floor Landing

Bedroom 1 14' 11" x 11' 11" (4.54m x 3.63m)

W.C 4' 4" x 4' 4" (1.32m x 1.32m)

Bedroom 2 15' 2" x 9' 10" (4.62m x 2.99m)

Rear Garden

Driveway



Boomin

Sunflowers
Estate Agents

rightmove

Zoopla





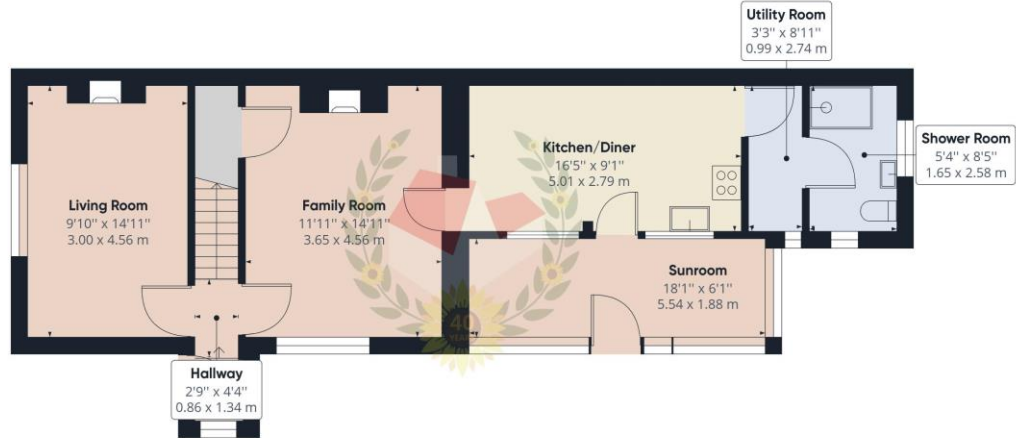

Ground Floor

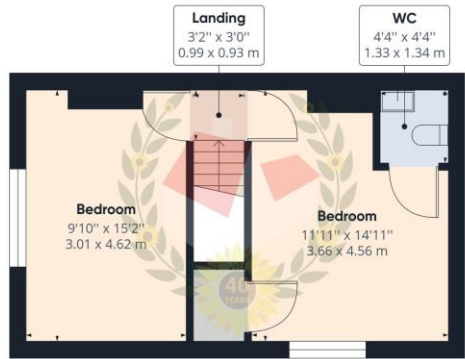

Floor 1



Approximate total area⁽¹⁾
1068.98 ft²
99.31 m²

(1) Excluding balconies and terraces

While every attempt has been made to ensure accuracy, all measurements are approximate, not to scale. This floor plan is for illustrative purposes only.

GIRAFFE360

FOR ILLUSTRATIVE PURPOSES ONLY – NOT TO SCALE

The position and size of doors, windows, appliances, and other features are approximate only.
Unauthorised reproduction prohibited

Important notice: Michael Tuck, its clients and any joints give notice that 1: They are not authorised to make or give any representations or warranties in relation to the property either here or elsewhere, either on their own behalf of their client or otherwise. They assume no responsibility for any statement that may be made in these particulars. These particulars do not form part of any offer or contract and must not be relied upon as statements or representation of fact. 2: Any areas, measurements or distances are approximate. The text, photographs and plans are for guidance only and are not necessarily comprehensive. It should not be assumed that the property has all necessary planning, building regulation or other consents and Michael Tuck have not tested any services, equipment or facilities. Purchasers must satisfy themselves by inspection or otherwise.

